



Control Your Video

**VIDEO WALLS VIDEO PROCESSORS
VIDEO MATRIX SWITCHES
EXTENDERS SPLITTERS WIRELESS
CABLES & ACCESSORIES**

4X4 HDMI 4K60 Matrix Switcher with HDR/IR/RS232/Telnet and Web GUI Support



Model #: SW-HDM2-T4K-4X4

© 2016 Avenview Inc. All rights reserved.

The contents of this document are provided in connection with Avenview Inc. ("Avenview") products. Avenview makes no representations or warranties with respect to the accuracy or completeness of the contents of this publication and reserves the right to make changes to specifications and product descriptions at any time without notice. No license, whether express, implied, or otherwise, to any intellectual property rights is granted by this publication. Except as set forth in Avenview Standard Terms and Conditions of Sale, Avenview assumes no liability whatsoever, and claims any express or implied warranty, relating to its products are strictly prohibited.

Product Application & Market Sectors



Corporate



House Of Worship



Military



Residential



Education



Industrial



Medical



Aviation



TABLE OF CONTENTS

1.	GETTING STARTED	1
1.1	IMPORTANT SAFEGUARDS.....	1
1.2	SAFETY INSTRUCTIONS	1
1.3	REGULATORY NOTICES FEDERAL COMMUNICATIONS COMMISSION (FCC)	2
2.	INTRODUCTION	3
2.1	PACKAGE CONTENTS	4
2.2.	BEFORE INSTALLATION.....	5
2.3	APPLICATION DIAGRAM.....	6
3.	PANEL DESCRIPTION	7
3.1	Front Panel	7
3.2	Rear Panel.....	9
4.	IR REMOTE CONTROL.....	10
5.	INSTALLATION	11
6.	SPECIFICATIONS	12
7.	INPUT/OUTPUT SUPPORT TIMING	13



SECTION I: GETTING STARTED

I.1 IMPORTANT SAFEGUARDS

Please read all of these instructions carefully before you use the Fiber Optic cable. Save this manual for future reference.

What the warranty does not cover

- Any product, on which the serial number has been defaced, modified or removed.
- Damage, deterioration or malfunction resulting from:
- Accident, misuse, neglect, fire, water, lightning, or other acts of nature, unauthorized product modification, or failure to follow instructions supplied with the product.
- Repair or attempted repair by anyone not authorized by us.
- Any damage of the product due to shipment.
- Removal or installation of the product.
- Causes external to the product, such as electric power fluctuation or failure.
- Use of supplies or parts not meeting our specifications.
- Normal wear and tear.
- Any other causes which does not relate to a product defect.
- Removal, installation, and set-up service charges.

I.2 SAFETY INSTRUCTIONS

The SW-HDM2-T4K, HDMI 4K Matrix Switcher has been tested for conformance to safety regulations and requirements, and has been certified for international use. However, like all electronic equipments, the SW-HDM2-T4K should be used with care. Read the following safety instructions to protect yourself from possible injury and to minimize the risk of damage to the unit.



- ⚠ Do not dismantle the housing or modify the module.
- ⚠ Dismantling the housing or modifying the module may result in electrical shock or burn.
- ⚠ Refer all servicing to qualified service personnel.
- ⚠ Do not attempt to service this product yourself as opening or removing housing may expose you to dangerous voltage or other hazards
- ⚠ Keep the module away from liquids.
- ⚠ Spillage into the housing may result in fire, electrical shock, or equipment damage. If an object or liquid falls or spills on to the housing, unplug the module immediately.
- ⚠ Have the module checked by a qualified service engineer before using it again.
- ⚠ Do not use liquid or aerosol cleaners to clean this unit. Always unplug the power to the device before cleaning.



1.3 REGULATORY NOTICES FEDERAL COMMUNICATIONS COMMISSION (FCC)

This equipment has been tested and found to comply with Part 15 of the FCC rules. These limits are designed to provide reasonable protection against harmful interference in a residential installation.

Any changes or modifications made to this equipment may void the user's authority to operate this equipment.

Warning symbols	Description
	<p>ONLY USE THE PROVIDED POWER CABLE OR POWER ADAPTER SUPPLIED. DO NOT TAMPER WITH THE ELECTRICAL PARTS. THIS MAY RESULT IN ELECTRICAL SHOCK OR BURN.</p>
	<p>DO NOT TAMPER WITH THE UNIT. DOING SO WILL VOID THE WARRANTY AND CONTINUED USE OF THE PRODUCT.</p>
	<p>THE VIDEO BOARDS ARE VERY SENSITIVE TO STATIC. PLEASE ENSURE IF RACK MOUNTED OR INSTALLED ON A SURFACE, IT SHOULD BE IN A GROUNDED ENVIROMENT.</p>

	<p>! WARNING</p>
	<p>Read & understand user guide before using this device.</p> <p>Failure to follow the proper installation instructions could result in damage to the product and preventing expected results.</p>

2. INTRODUCTION

The SW-HDMI2-T4K matrix switcher features four HDMI inputs and four HDMI outputs. It provides true matrix routing for HDMI signals. It supports the transmission of video (resolutions up to 2160p@60Hz Ultra HD 4:4:4) and supports high resolution digital audio formats such as LPCM 7.1CH, Dolby TrueHD, Dolby Digital Plus and DTS-HD Master Audio. It works with Blue-Ray players, Set-Top boxes, Home Theater PCs, and game consoles. Inputs and outputs switching are accessible at all times via IR Remote Control, RS-232, TCP/IP or the selection buttons on the front panel. This device supports all HDMI 3D formats.

FEATURES:

- HDMI2.0, HDCP2.2/HDCP1.4 compliant
- Support video format up to 4K2K@60Hz with 24bit RGB/YCbCr 4:4:4/YCbCr 4:2:2, and up to 4k2k@60Hz with 12bit YCBCR 4:2:0
- Support color space conversions among RGB, YCbCr4:4:4, YCbCr4:2:2 and xvYCC video formats
- Support all HDMI 3D formats up to 2160p@30
- Support high resolution VESA mode video format up to QSXGA@60Hz
- Support reception of any audio data conforming to the HDMI specification such PCM at up to 192kHz, compressed audio (IEC 61937), DSD, DST, DTS and HBR
- Support simultaneous HDMI Coax and L/R audio outputs
- Support smart EDID management
- Support RS-232, remote control, on-panel control and TCP/IP Control



2.1 PACKAGE CONTENTS

Before starting setup, please check the package contents.

1	SW-HDM2-T4K-4X4	X 1	
2	Power Supply (12V 2.5A)	X 1	
3	IR Remote	X 1	
4	IR Receiver Cable	X 1	
5	Mounting ears	X 2	
6	User's Manual	X 1	



2.2. BEFORE INSTALLATION

- Put the product in an even and stable location. If the product falls down or drops, it may cause an injury or malfunction.
- Don't place the product in too high temperature (over 50°C), too low temperature (under 0°C) or high humidity.
- Use the DC power adapter with correct specifications. If inappropriate power supply is used then it may cause a fire.
- Do not twist or pull by force ends of the video cable. It can cause malfunction.



2.3 APPLICATION DIAGRAM

SW-HDM2-T4K-4X4

CABLE INDEX

- Input/Output
- Digital and Analog AUDIO
- Control CAT5E/6
- Control RS232

4K(4096X2160) = 5m (16 feet) HDMI
 UHD(3840X2160) = 5m (16 feet) HDMI
 FHD(1920X1080) = 15m (50 feet) HDMI
MATRIX FUNCTION
 LAYOUT 1



3. PANEL DESCRIPTION

3.1 Front Panel

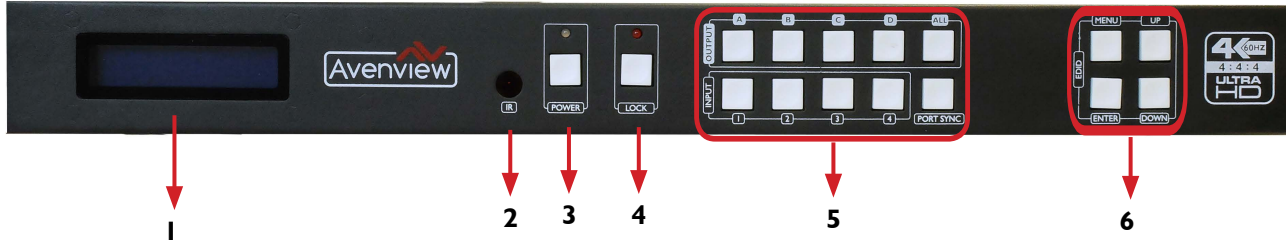

<p>1. LCM: Liquid Crystal Monitor displays device status and selections</p>	<p>2. IR Window: Receives IR signals from the device remote control (Included in package)</p>
<p>3. Power Button: Toggle ON/OFF First Press Power On, Second Press Standby Mode. Note : Quick Factory Reset HOLD power button then connect power supply to the unit.</p>	<p>4. Lock Button : Shows the OSD Menu on the screen Menu with “-“ button : switches the output timing to 720@60Hz Menu with “+“ button : switches the output timing to XGA (1024x768@60Hz)</p>
<p>5. Input IN 1- IN 4 /Output OUT1- OUT4: Press OUTPUT and INPUT buttons to select the output corresponding input. e.g: Press OUTPUT ALL > INPUT 1, The OUTPUT A, B, C, D will be set to INPUT 1. Press PTP button, The OUTPUT A, B, C, D will be corresponding INPUT 1, 2, 3, 4</p>	<p>6. EDID: Smart EDID management, the LCM will display the EDID operation. Press the MENU button and enter the EDID management window. Press UP or DOWN button to select the needed EDID setting. Press ENTER button to download EDID into input source, it can easily download any EDID setting to any input port. <i>Check page 8 for more details</i></p>



EDID MODES

EDID Mode	EDID Description
1	1080p, 2CH AUDIO
2	1080p, DOLBY/DTS 5.1
3	1080p, HD AUDIO
4	1080i, 2CH AUDIO
5	1080i, DOLBY/DTS5.1
6	1080i, HD AUDIO
7	3D, 1080p, 2CH AUDIO
8	3D, 1080p, DOLBY/DTS 5.1
9	3D, 1080p, HD AUDIO
10	4K30_444, 2CH AUDIO
11	4K30_444, DOLBY/DTS 5.1
12	4K30_444, HD AUDIO
13	4K60_420, 2CH AUDIO
14	4K60_420, DOLBY/DTS 5.1
15	4K60_420, HD AUDIO
16	4K60_444, 2CH AUDIO
17	4K60_444, DOLBY/DTS 5.1
18	4K60_444, HD AUDIO
19	Copy from HDMI OUTPUT A
20	Copy from HDMI OUTPUT B
21	Copy from HDMI OUTPUT C
22	Copy from HDMI OUTPUT D



3.2 Rear Panel

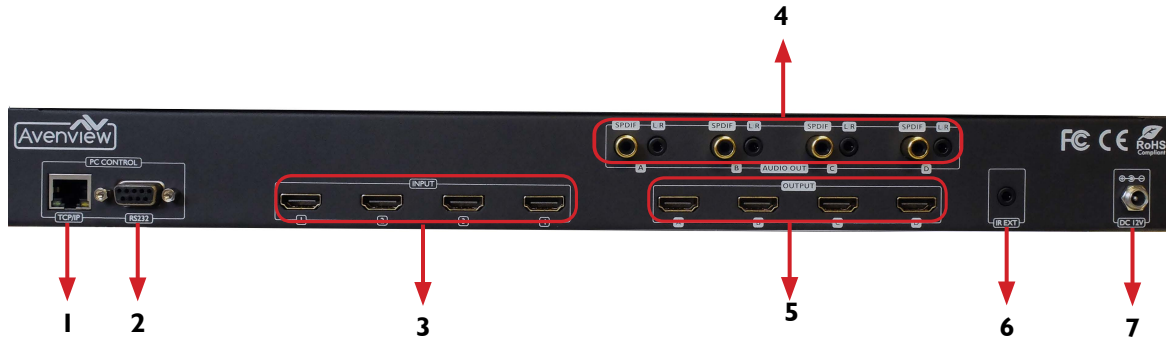

<p>1. TCP/IP: This port is the link for TCP/IP control and connects to an active Ethernet link by an RJ-45 cable.</p>	<p>2. RS 232: Connect to a PC or control system by D-Sub 9-pin cable for the transmission of RS-232 commands.</p>
<p>3. HDMI INPUT: Connect to the HDMI sources device such as a DVD player or a Set-top Box by HDMI cable.</p>	<p>4. AUDIO OUTPUT: The coaxial and L/R audio output to audio amplifiers or speakers.</p>
<p>5. HDMI OUTPUT: Connect to HDMI equipped TVs or monitors.</p>	<p>6. IR EXT: If the front IR sensor of unit is obstructed or the unit is installed in a closed area out of infrared line of sight, the IR RX receiver included can be inserted into the IR EXT port at the rear to extend the IR sensor range and enable local control of the matrix.</p>
<p>7. DC POWER INPUT: Connect to 12V/2.5A DC power adapter.</p>	



4. IR REMOTE CONTROL

- POWER BUTTON:** Powers on the switcher or set it to standby mode
- OUTPUT SELECTION:** Select INPUT source (1, 2, 3, 4) on each OUTPUT (A, B, C, D) port

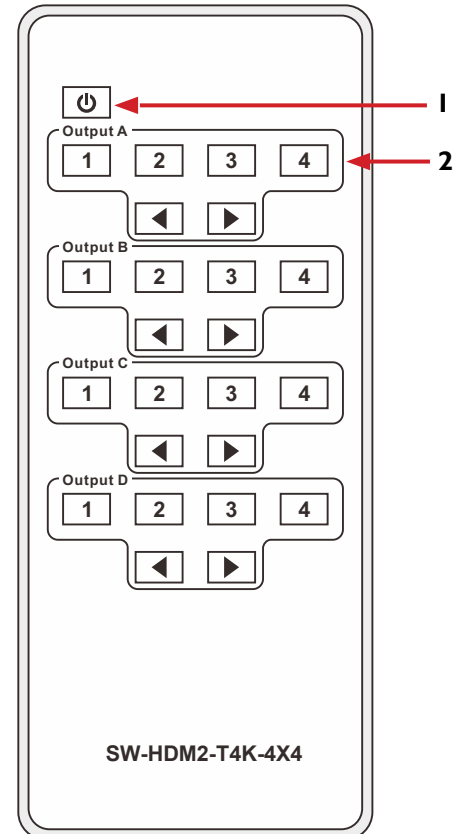

5. INSTALLATION

1. Connect up to 4 sources such as a Blue-Ray Player, game console, A/V Receiver, Cable or Satellite Receiver, etc. to each HDMI input port. Do not hot plug. Plug and unplug HDMI cords carefully with the power switched off. Connecting and disconnecting while the unit is powered on can result in permanent damage.
2. Connect each HDMI output to high-definition displays such as a HDTV or HD projector that has HDMI input. Note that high-speed HDMI cables are recommended for the distances that are required for each connection.
3. Plug in the IR receiver cord to IR EXT on the matrix switch for remote control functions.
4. Plug in DC power adapter to power on the matrix switch then power on each display and input source.



6. SPECIFICATIONS

Item	Description
UNITS	SW-HDM2-T4K-4X4
UNIT DESCRIPTION	4X4 HDMI 4K60 Matrix Switcher
HDCP COMPLIANCE	Yes
VIDEO BANDWIDTH	594MHz [18Gbps]
SUPPORTED RESOLUTIONS	480i, 576i, 480p, 576p, 720p, 1080i, 1080p24/30/50/60, 2160p24/25/30/50/60;
INPUT	4×HDMI, 1×IR Receiver, 1×RS-232, 1×RJ-45(Control)
OUTPUT	4×HDMI, 4×Toslink, 4×L/R
3.5mm CONNECTOR	IR Receiver
RJ45 CONNECTOR	WE/SS 8P8C with 2 LED indicators
CHASSIS MATERIAL	Metal
UNIT WEIGHT	4 lbs
DIMENSIONS (L X W X H)	17.2" x 8" x 1.8"
POWER SUPPLY	12V/2.5A DC (US/EU standards, CE/FCC/UL certified)
POWER CONSUMPTION	9 W (max)

ENVIRONMENTAL

OPERATING TEMPERATURE	32° ~ 104°F (0° to 40°C)
STORAGE TEMPERATURE	-4° ~ 140°F (-20° ~ 60°C)
RELATIVE HUMIDITY	20~90% RH (no condensation)



7. INPUT/OUTPUT SUPPORT TIMING

7.1 Input Support Resolution

INPUT SUPPORT RESOLUTION
480i@59
480p@60
576i@50
576p@50
720p@25,30,50,60,
1080i@50,60
1080p@24,25,30,50,60
640x480@60,72,75,85
720x400@70
800x600@56,60,72,75,85
1024x768@60,70,75,85
1152x864@70,75
1280x720@60cvt
1280x768@60RB,60,75
1280x800@60RB,60,75
1280x1024@60,60cvt,75
1360x768@60
1366x768@60RB,60
1400x1050@60RB,60
1440x900@60RB,60,75
1600x900@60RB
1600x1200@60
1680x1050@60RB,60
1920x1200@24/30/50/60RB
3840x2160@24/25/30/50/60RB
4096x2160@24/25/30/50/60RB

7.2 Output Support Resolution

VIDEO RESOLUTION	PC RESOLUTION
480p60	1024x768@60
576p50	1280x800@60
720p50	1280x1024@60
720p60	1366x768@60
1080i50	1440x900@60
1080i60	1600x900@60RB
1080p24	1600x1200@60
1080p50	1680x1050@60
1080p60	1920x1200@60RB
2160p50	3840x2160@60RB
2160p60	4096x2160@60



Notes



Notes



Avenview Warranty Certificate

AVENVIEW CORP. ("Avenview") warrants Avenview-branded product(s) contained in the original packaging against defects in materials and workmanship when used normally in accordance with Avenview's enclosed manual guidelines for a period of THREE (3) YEARS from the date of original retail purchase - Warranty Period. Avenview's published guidelines include but are not limited to information contained in technical specifications, user manuals and service communications.

LABOR: During the Warranty Period of THREE (3) YEARS, Avenview will repair or replace the product(s) at no cost using new or used parts equivalent to novel performance and reliability if the product(s) is determined to have abide by Avenview's published guidelines. Cost of Labor applicable to product(s) after Warranty Period. For labor costs, please contact support@avenview.com.

PARTS: During the Warranty Period of THREE (3) YEARS, Avenview will supply new or rebuilt replacements in exchange for defective parts of the product(s) at no cost if the product(s) is determined to have abide by Avenview's published guidelines. Cost of Parts applicable to product(s) after Warranty Period. For part(s) costs, please contact support@avenview.com.

To obtain Warranty: (a) proof of purchase in the form of a bill of sale or receipted invoice reflecting that the registered product(s) is within warranty period must be presented to obtain warranty service; (b) product(s) must be registered at time of purchase. Failure to do so will result in applicable parts and labor charges. Returning product(s) must be shipped in Avenview's original packaging or in packaging pertaining equal degree of protection to Avenview's. Both Avenview and purchaser are responsible for freight charges and brokerages when shipping the product(s) to the receiver.

NOT COVERED BY THIS WARRANTY

This warranty does not apply to any non-Avenview branded product(s); non-registered Avenview product(s). This warranty does not apply: (a) to cosmetic damage, including but not limited to scratches, dents and broken cords; (b) to damage caused by use with another product; (c) to damage caused by accident, abuse, misuse, liquid contact, fire, earthquake or other external cause; (d) to damage caused by operating the Avenview product(s) outside Avenview's manuals or guidelines; (e) to damage caused by service performed by anyone who is not a representative of Avenview or an Avenview authorized personnel; (f) to defects caused by normal wear and tear or otherwise due to the normal aging of the Avenview product(s), or (g) if any serial number has been removed or defaced from the Avenview product(s).

AVENVIEW IS NOT LIABLE FOR DIRECT, SPECIAL, INCIDENTAL OR CONSEQUENTIAL DAMAGES RESULTING FROM ANY BREACH OF WARRANTY OR CONDITION, OR UNDER ANY OTHER LEGAL THEORY, INCLUDING BUT NOT LIMITED TO LOSS OF USE; LOSS OF REVENUE; LOSS OF ACTUAL OR ANTICIPATED PROFITS (INCLUDING LOSS OF PROFITS ON CONTRACTS); LOSS OF THE USE OF MONEY; LOSS OF ANTICIPATED SAVINGS; LOSS OF BUSINESS; LOSS OF OPPORTUNITY; LOSS OF GOODWILL; LOSS OF REPUTATION; LOSS OF, DAMAGE TO, COMPROMISE OR CORRUPTION OF DATA; OR ANY INDIRECT OR CONSEQUENTIAL LOSS OR DAMAGE REPAIR OR REPLACEMENT AS PROVIDED UNDER THIS WARRANTY IS THE EXCLUSIVE REMEDY OF THE CONSUMER.

Some states do not allow the inclusion or limitation of incidental or consequential damages, or allow limitations on duration implements of the Warranty Period; therefore the above limitations or exclusions may not be applicable to you. This warranty gives you specific legal rights, and you may have other rights which vary from state to state.



1100 Military Rd., Kenmore, NY 14217
1.866.508.0269





AV Connectivity, Distribution And Beyond...

TECHNICAL SUPPORT

CONTACT US



Phone: 1 (866) 508 0269



Email: support@avenview.com



Avenview Canada

151 Esna Park Drive, Unit 11-12
Markham, ON L3R 3B1
Phone: +1 905 907 0525
Email: info@avenview.com
Sales: sales@avenview.com

Avenview USA

1100 Military Road
Kenmore, NY 14217
Phone: +1 716 218 4100 x223
Fax: +1 866 387 8764 Email:
info@avenview.com

Avenview Europe

Phone: +31 085 2100 613
Email: info@avenview.eu

Avenview Asia

Email: wenxi@avenview.com.hk
Sales: sales@avenview.com.hk

Disclaimer

While every precaution has been taken in the preparation of this document, Avenview Inc. assumes no liability with respect to the operation or use of Avenview hardware, software or other products and documentation described herein, for any act or omission of Avenview concerning such products or this documentation, for any interruption of service, loss or interruption of business, loss of anticipatory profits, or for punitive, incidental or consequential damages in connection with the furnishing, performance, or use of the Avenview hardware, software, or other products and documentation provided herein.

Avenview Inc. reserves the right to make changes without further notice to a product or system described herein to improve reliability, function or design. With respect to Avenview products which this document relates, Avenview disclaims all express or implied warranties regarding such products, including but not limited to, the implied warranties of merchantability, fitness for a particular purpose, and non-infringement.