

DVI-PROWALL-4X

4 Display Videowall Processor
 with Audio Support and Rotation

VIDEO WALL PROCESSOR



KEY FEATURES

- 4 DVI/HDMI outputs (640x480 to 1920x1200);
- Supports HDMI/DVI input, from 640x480 to 1920x1200@60 i/p;
- Supports 1080p/WUXGA
- Auto save image parameters and layouts;
- Upgradable Firmware;
- Supports IR remote control;
- Software control through USB and Ethernet;
- Supports input rotation, resize, position, zoom output video;
- User-selectable output settings, up to 1920x1200;
- Each DVI/HDMI output has an independent controllable display area;
- Supports remote control to switch 1x1, 2x2, 1x3 rotate, and 1x4 rotate mode

MECHANICAL SPECIFICATIONS

Housing	Metal Case
Dimensions / Net Weight	11.3" x 7" x 1.7" / 5.733lbs
Fixedness	1U rack-mount with ears and wall holes 2V
Power Supply	12V 5A DC / 110-240V
Power Consumption	7.6W
Operating Temperature	0~40°C [32~104°F]
Storage Temperature Relative	20~60°C [-4~140°F]
Humidity	20~90% RH [No Condensation]

PANEL DESCRIPTION

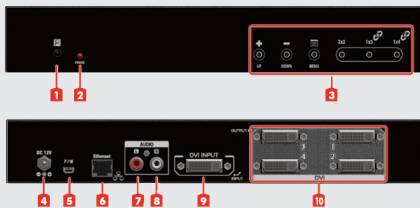

- | | |
|----------------------------------|----------------------------------|
| 1 IR Sender | 2 Power Status |
| 3 Control Buttons | 4 DC Power Jack |
| 5 USB Virtual COM | 6 Ethernet |
| 7 Stereo Audio Output - L | 8 Stereo Audio Output - R |
| 9 Input | 10 Output 1-4 |



LAYOUT - MIXED VIDEOWALL (Portrait and Landscape mixed screens)

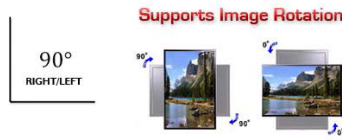

ITEM

SPECIFICATION

Description	Video Wall Processor
Output Displays	4 Displays 640 x 480 to 1920 x 1080 resolutions / PC Resolution 1920 x 1200
Input Format Support	DVI/HDMI (640 x 480 to 1920 x 1080 resolutions)
Output Format Support	DVI/HDMI
Video Loop Out	No
HDCP Video Compliance	Yes
Video Bandwidth	DVI [Single-link 4.95Gbps], HDMI [2.25G to 6.75Gbps]
Input Video Support	Up to 1920x1200@60 / 1600x1200@60
Audio Support	Yes
Control	IR remote control / Ethernet / USB (virtual com) / Front Panel
Input TMDS Signal ESD	1.2 Volts [Peak-to-Peak]
Protection	Human Body Model - 19kV [Air-gap Discharge] & 12kV [Contact Discharge]
PCB Stack-Up	8-Layer Board [Impedance Control-Differential 100Ω; Single 50Ω]
DVI Connector	DVI-I [29-pin female, digital only]
USB Connector	Type A
Output	4x DVI-D + 1x Stereo
Input	1x DVI-D + 1x USB + 1xRJ45
RJ45 Connector	WE/SS 8P8C

DVI-PROWALL-4X

LAYOUT - 2x2 VIDEOWALL

CABLE INDEX

- Output ■
- Input / Source ■
- Audio ■
- USB ■
- CAT-5 / CAT-6 ■



8 QUICK STYLE LAYOUTS

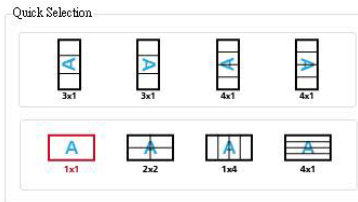

IR REMOTE

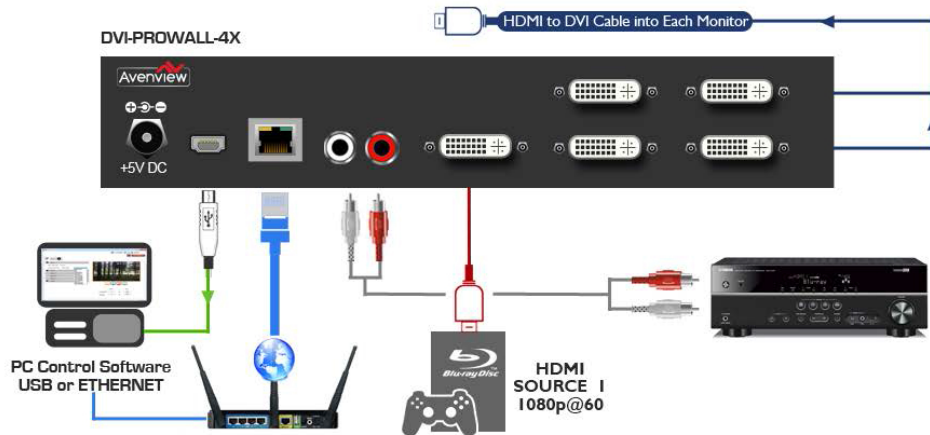

Combine DVI-PROWALL-4X with the DVI-SPLITPRO4X/4A to achieve multiple digital inputs and add more screens to your video wall. Easily control your video with adjusting size, positioning, screen splitting, video converting to video switching using controller software.

Avenview USA
Avenview Head Office
275 Woodward Avenue
Kenmore, NY 14217
Phone: 1.716.218.4100
Fax: 1.866.387.8764
Email: info@avenview.com

Avenview Canada
Avenview Sales
151 Esna Park Drive, Units 11 & 12
Markham, ON, L3R 3B1
Phone: 1.905.907.0525
Fax: 1.866.387.8764
Email: info@avenview.com

Avenview Europe
Avenview Europe
Demkweg 11
3555 HW Utrecht
Netherlands
Phone: +31(0)85.2100.613
Email: info@avenview.eu

Avenview Hong Kong
Unit 8, 6/F, Kwai Cheong Centre,
50 Kwai Cheong Road,
Kwai Chung, N.T.
Hong Kong
Phone: 852.3575.9585
Email: asia@avenview.com